

GENERAL NOTES:

REFER TO BCA PART D & REFERENCED AS1428.1, AS1428.4.1 & AS2890.6 FOR STATUTORY REQUIREMENTS SPECIFIC TO THE PROVISIONS OF DISABILITY ACCESS REQUIREMENTS

EXIT DOORS:

ALL EXIT DOORS TO BE OPENABLE FROM INSIDE WITHOUT THE USE OF A KEY BY A SINGLE HANDED DOWNWARD MOTION. LATCHING DEVICE TO BE LOCATED BETWEEN 900-1100mm FROM FINISHED FLOOR LEVEL.

ACCESS FOR DISABLED:

ACCESS FOR PEOPLE WITH DISABILITIES MUST BE PROVIDED BY MEANS OF A CONTINUOUS PATH OF TRAVEL IN ACCORDANCE WITH AS.1428.1-2009 MAX PATH SLOPE 1:20 FOR WALKWAYS - 1:40 CROSSFALL. MAXIMUM 5mm ROUNDED STEP AT DISABLED ENTRY POINTS.

CEILING:

USE ARMSTRONG CIRBUS .20mm THICK MINERAL FIBRE OR SIMILAR.

GLAZING:

ALL GLAZING TO COMPLY TO AS.1288-2006 AND AS.2047. USE 125x50 COMMERCIAL ALUMINIUM FRAMED SECTION. GLASS TO BE SUPPORTED AT ALL EDGES. FOR DOORS & SIDE PANELS - USE 6mm TOUGHENED SAFETY GLASS, MAX PANEL 4 sqm. DECALS TO BE INSTALLED TO ALL FULL HEIGHT GLAZING MIN 75mm SOLID LINE LOCATED BETWEEN 900-1000mm FROM FINISHED FLOOR LEVEL. ELSEWHERE - USE 6mm ORDINARY ANNEALED GLASS, MAX PANEL 3.3 sqm.

GLASS:

USE A THERMAL TRANSMISSION "U"=4, SOLAR SHADE COEFFICIENT SC=0.45 OR BETTER. TINTED GLASS TO BE PILKINGTON RANGE. CLIENT RESERVES THE RIGHT TO CHOOSE ANY COLOR TINT FROM THE PILKINGTON RANGE.

FIRE PRECAUTIONS DURING CONSTRUCTION:

IN A BUILDING UNDER CONSTRUCTION PROVIDE NOT LESS THAN ONE FIRE EXTINGUISHER TO SUIT CLASS A, B & C FIRES AND ELECTRICAL FIRES MUST BE PROVIDED AT ALL TIMES ON EACH STORY ADJACENT TO EACH REQUIRED EXIT OR STAIRWAY OR EXIT.

SERVICE REPORT:

THE OWNER IS TO PROVIDE AN ESSENTIAL SERVICE REPORT IN KEEPING WITH THE BUILDING REGULATIONS 2018.

FIRE INDICES:

FIRE HAZARD PROPERTIES OF COMBUSTIBLE MATERIAL TO COMPLY TO BCA REGULATION C1.10

SIGNAGE FOR DISABLED AMENITIES:

ALL SIGNAGE FOR DISABLED AMENITIES TO COMPLY TO BCA CLAUSE D3.6

NOTES - STATUTORY REQUIREMENTS REFERENCE:

REFER TO AS1428.1-2009 DESIGN FOR ACCESS & MOBILITY REQUIREMENTS FOR ACCESS - NEW BUILDING WORK

ACCESSIBLE SANITARY FACILITY/IES - AS1428.1 - 2009 CLAUSE 15
AMBULANT SANITARY FACILITY/IES....- AS1428.1 - 2009 CLAUSE 16
HANDRAIL DETAILS- AS1428.1 - 2009 CLAUSE 12
STAIRWAYS.....- AS1428.1 - 2009 CLAUSE 11
LIFT INTERNALS I.E. CONTROLS & HANDRAILS - AS1735 SUITE

DOORWAY CONTROLS & ASSOCIATED HARDWARE - AS1428.1 - 2009 CLAUSE 13.5

LUMINANCE CONTRAST PERCENTAGES FOR:

STAIR NOSINGS.....-AS1428.1-2009 CLAUSE 11.1
DOORWAY/S (LEAF, WALL JAMB).....-AS1428.1-2009 CLAUSE 13.1
TGSi's.....-AS1428.4.1-2009
CONTRASTING STRIP ON GLAZING -AS1428.1-2009 CLAUSE 6.6

SIGNAGE SCHEDULE INCLUSIVE OF:

ACCESSIBLE SANITARY FACILITY/EIS -AS1428.1-2009 CLAUSE 8
AMBULANT SANITARY FACILITY/EIS....-AS1428.1-2009 CLAUSE 8
EXITS.....-BCA D3.6 (a) (ii)
LIFT CONTROLS-AS1735 SUITE
WAYFINDING.....-AS1428.1-2009 CLAUSE 8
ACCESSIBLE PARKING-AS2890 SUITE

ACCESSIBLE PARKING DELINEATION SET OUT @ COLOUR SPECS - AS2890 SUITE

PROVIDE CONTRASTING STRIP, CHAIR RAIL, HANDRAIL OR TRANSOM ACROSS ALL FRAMELESS OR FULLY OR FULLY GLAZED DOORWAYS AND SURROUNDING GLAZING CAPABLE OF BEING MISTAKEN FOR AN OPENING.

WATERPROOFING OF WET AREAS TO BE IN ACCORDANCE WITH AS3740.

ARTIFICIAL LIGHTING TO COMPLY WITH AS1680 AND BCA PART J.

EXIT SIGN AND EMERGENCY LIGHTS TO COMPLY WITH AS2293.1.

ALTERATION TO MECHANICAL VENTILATION SYSTEM TO SUIT NEW LAYOUT AND RE-BALANCING TO BE ACCORDANCE WITH AS1668.2-2012.

SPRINKLERS TO SUIT NEW LAYOUT AS PER AS2118.



TYPE A - Full height partition, 2.7m in height with metal studs, lined with 13mm plasterboard both sides

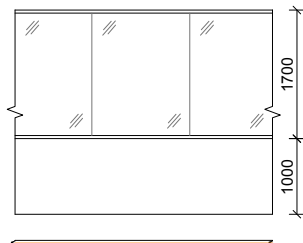

TYPE C - Plaster and Glass Partitions, 2.7m in height, plaster 1m, glass 1.7m in height finished in anodized aluminium

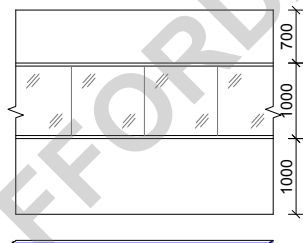

TYPE D - Plaster, Glass, Plaster partitions, 2.7m in height, plaster 1m, glass 1m, 0.7m plaster finished in anodised aluminium

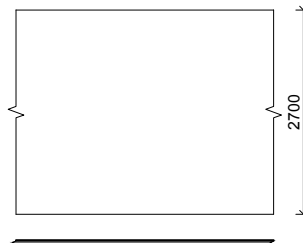

TYPE E - Masonry walls, battened and lined with 13mm plasterboard one side to 2.7m in height finished with bead to ceiling finished in anodized aluminium

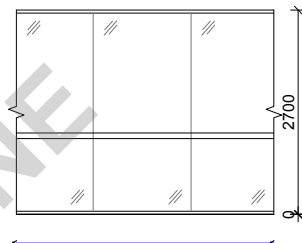

MULTI GLAZE - System 90 Partitions, full height glass (2.7m) to Australian standards finished in anodised aluminium

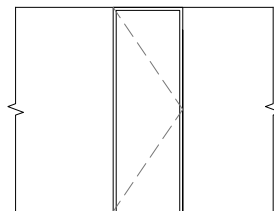

MDF light weight doors (920x2700) with hinges and internal door furniture

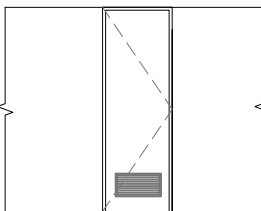

MDF light weight doors (920x2700) with mechanical grills, hinges and internal door furniture

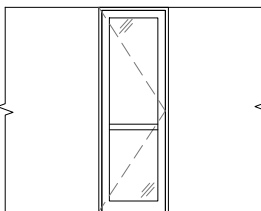

Aluminium glass doors (920x2700) with hinges and internal door furniture

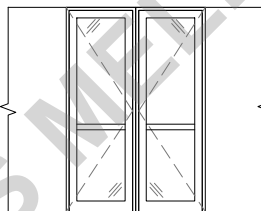

Aluminium double glass doors (1840x2700) with hinges and internal door furniture

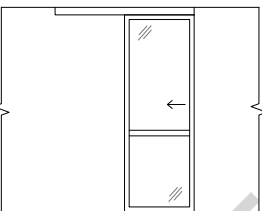

Aluminium glass sliding doors (920x2700) with internal door furniture



ORIENTATION

Revision		
No	Description	Date
1	Revised Layout	02.11.2018

EXISTING CONDITIONS NOTES:
All existing measurements, materials, levels and structures are approximate only. Contractor/builder to verify all existing conditions on site prior to any works commencing.

PARTITION NOTE:
Skirting to core or internal partitions is to be 100mm high aluminium and must be concealed fixed.

CIRCULATION NOTE
Circulation space at doorways in accordance with AS 1428.1

PAINT NOTE
All paint is to be of the low sheen washable type, with a minimum of two colour coats to be painted over the primer or base coat. As outlined in 6.19, all paint is to contain no or minimal levels of VOCs, with the maximum VOC level not to exceed 75g/litre of VOCs for any paint.

WINDOW AND DOOR NOTES :
All glazing to comply with AS 1288 window materials, constructions and installation to comply with AS 2047. Door and window sizes are nominal, builder/contractor to confirm exact measurements on site prior to manufacture. All door handle to be located 1000MM above FFL.

LEGEND:

WALLS

- Existing Wall
- New Plaster Wall
- New Glazed Wall
- New Type"C" Wall

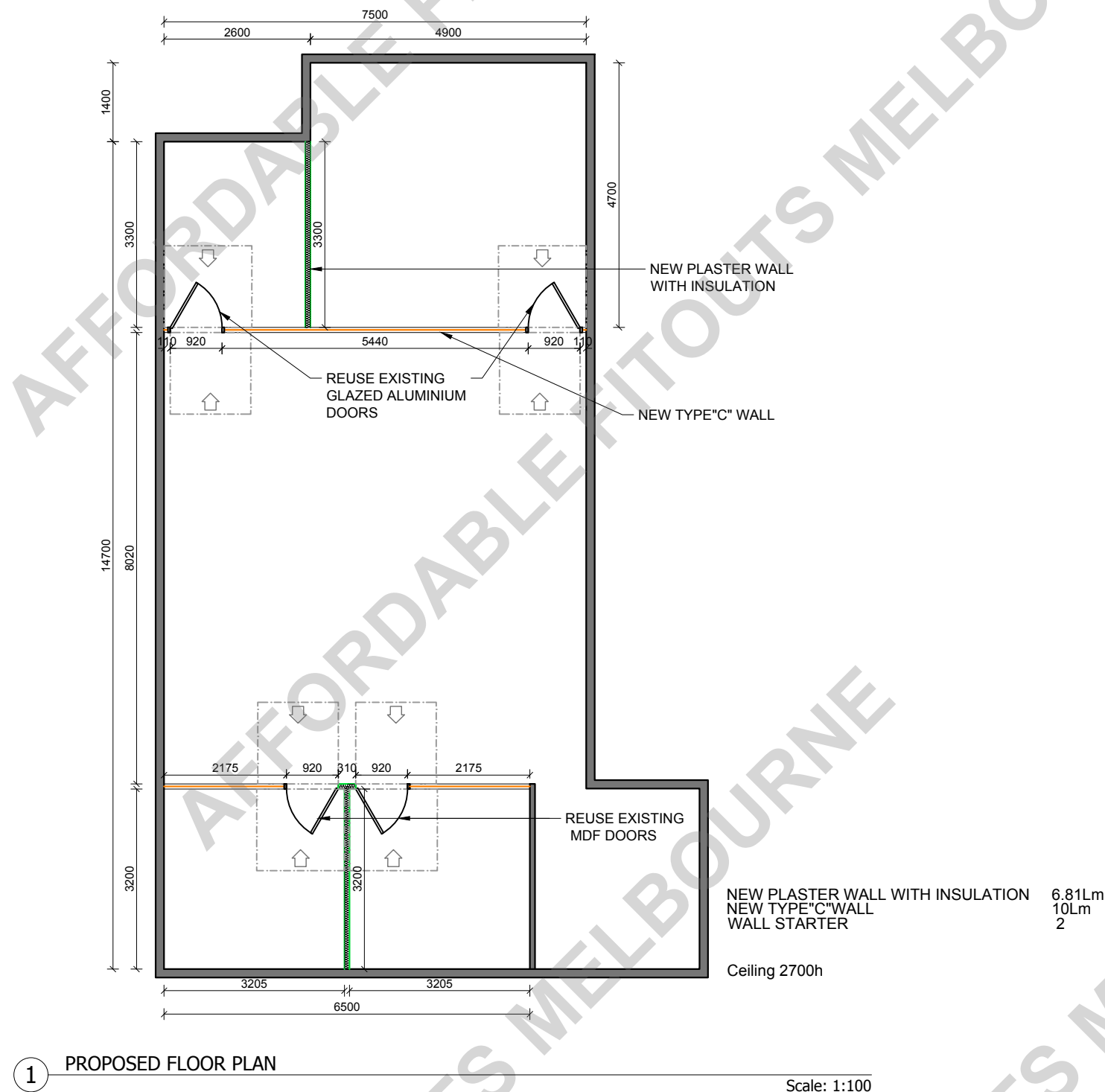

Revision		
No	Description	Date
1	Revised Layout	02.11.2018